

### Touch display and sensor controls

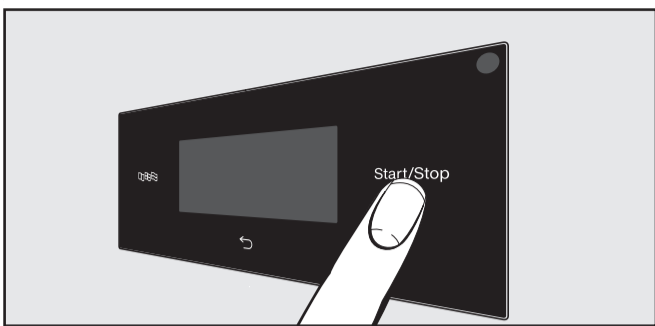

- To switch on: press the button. The , and *Start/Stop* sensor controls and the sensor controls in the display react to finger tip contact.

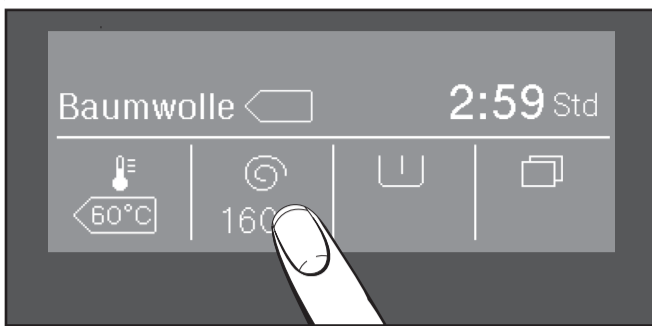

You can change the temperature and the spin speed by touching the and sensor controls. You can use the and sensor controls to select *Pre-wash* and *Rinse plus* respectively.

### 1 Selecting the language

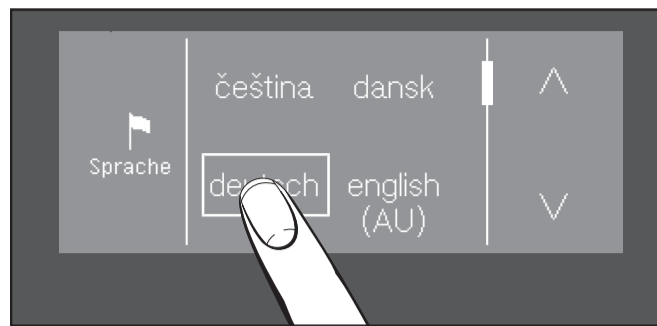

- Touch the sensor control.
- Touch the or sensor control until the language you want appears in the display.
- Select the language.

### 2 Loading the laundry

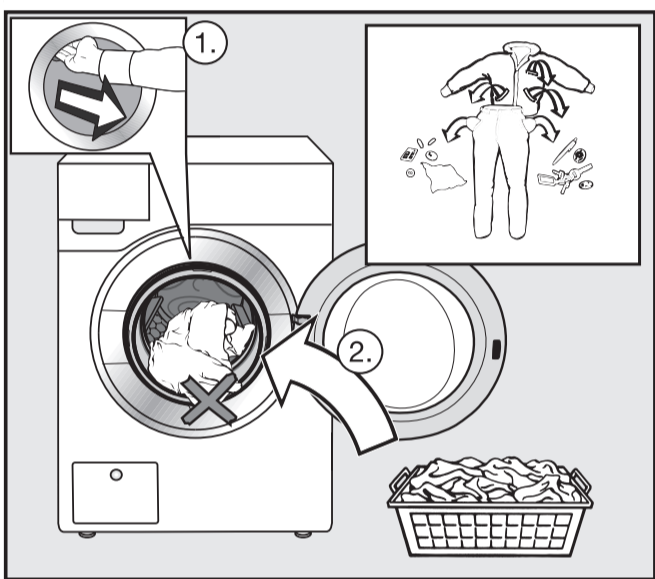

- Open the door.
- Load the laundry, sorted by colour and care label.
- Shut the door with a gentle swing. Make sure items do not get caught in the door.

### 3 Adding detergent

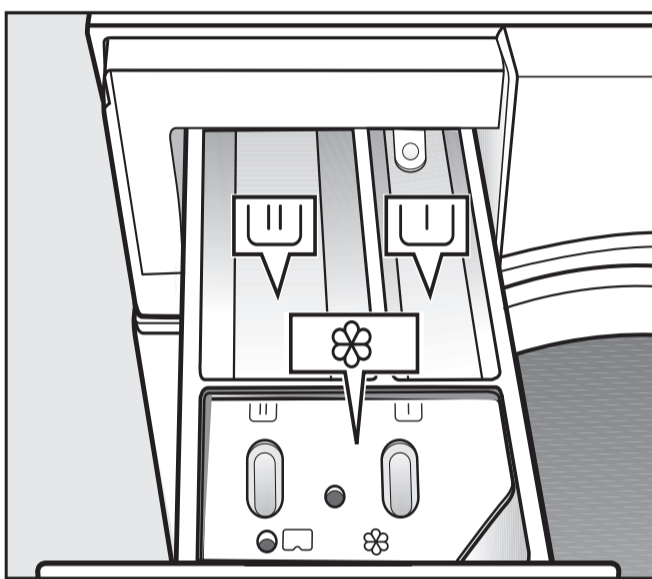

- Detergent for the pre-wash.
- Detergent for the main wash.
- Fabric conditioner or liquid starch.

### 4 Selecting and starting the programme

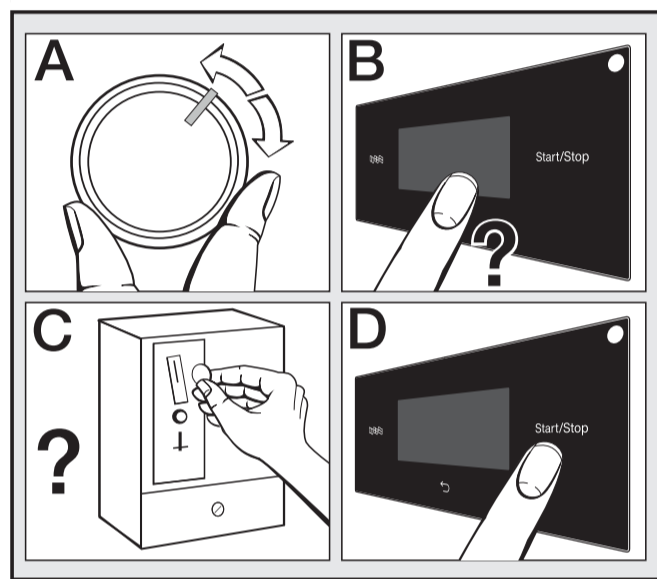

- Select a programme (A).
- Select the temperature, spin speed and Extras (B).
- Insert payment (C).
- Touch the *Start/Stop* sensor control (D).

### 5 Unloading the laundry

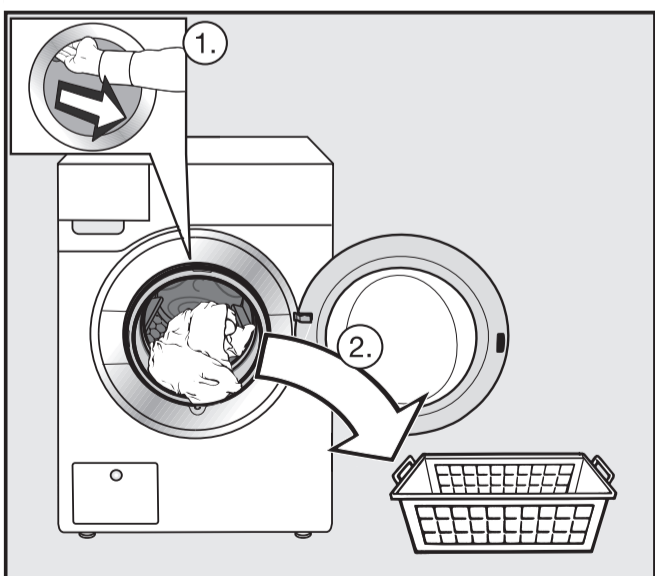

- Anti-crease/Finish* appears on the display.
- Release the door with the *Start/Stop* sensor control.
  - Open the door and remove the laundry.

### Opening the door in the event of a power failure

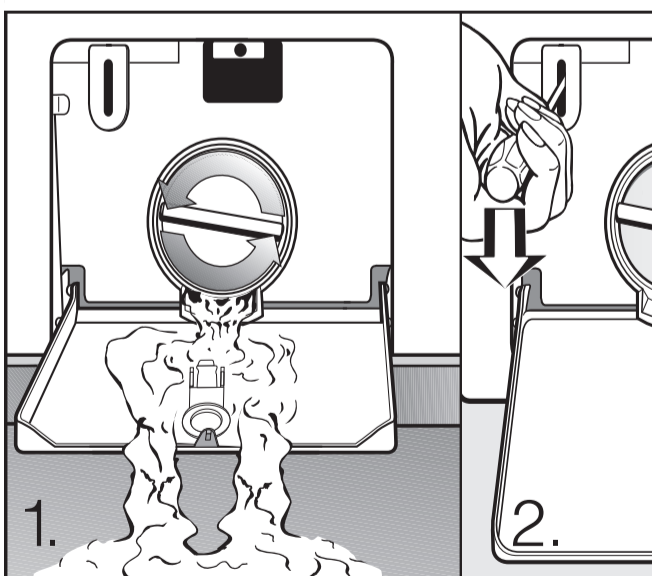





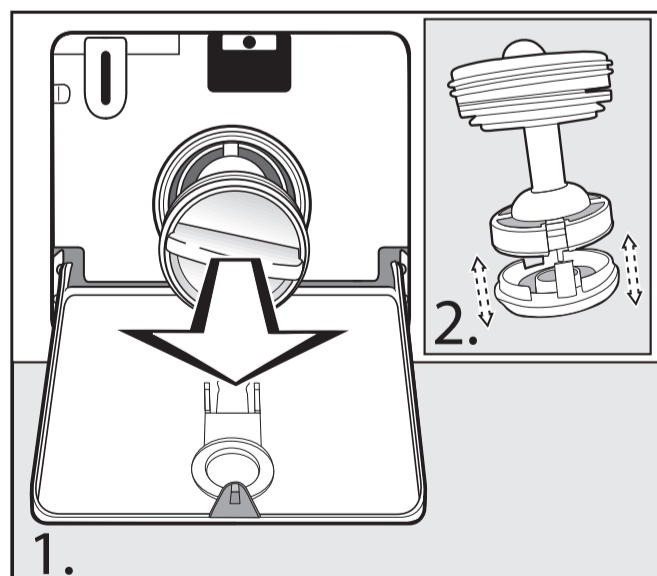





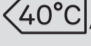
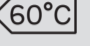

- Open the access panel to the drainage system.
- Allow the water to drain off. Be careful: the water may be hot.
- Release the door with a screwdriver.

### Cleaning the drain filter



- Allow the water to drain off.
- Unscrew the drain filter completely.
- Clean the drain filter thoroughly.
- Replace the drain filter and tighten it securely.



Programme		Load
 <b>Cottons 20 °C to 90 °C</b>		<b>max. 7.0 kg</b>
Use for	Cotton, linen and mixed fibre textiles.	
Tip	<ul style="list-style-type: none"> <li>– Select the temperature according to the instructions on the care label, the detergent, the type of soiling and the hygiene requirements.</li> <li>– For dark-coloured fabric, use a colour detergent or liquid detergent.</li> </ul>	
Extras	– Pre-wash 	
 <b>Cottons</b>  / 		<b>max. 7.0 kg</b>
Use for	Normally soiled cotton items.	
Tip	<ul style="list-style-type: none"> <li>– These settings are the most efficient in terms of energy and water consumption for washing cottons. With , the wash temperature reached is below 60 °C.</li> </ul>	
Extras	– Pre-wash 	
 <b>Express 30 °C</b>		<b>max. 3.5 kg</b>
Use for	Cotton garments that have hardly been worn or are only very lightly soiled.	
Extras	– Rinse plus 	
 <b>Minimum iron 30 °C to 40 °C</b>		<b>max. 3.5 kg</b>
Use for	Synthetic and mixed fibre textiles as well as easy care cotton.	
Tip	– Reduce the final spin speed for fabric that creases easily.	
Extras	– Pre-wash 	
 <b>Delicates 30 °C</b>		<b>max. 2.5 kg</b>
Use for	Delicate garments made from synthetic fibre, mixed fibre and viscose.	
Tip	<ul style="list-style-type: none"> <li>– Wash textiles containing wool or silk in the Woollens or Silks programme.</li> <li>– Deselect the final spin speed for fabric that creases easily.</li> <li>– Use detergent for delicates.</li> </ul>	
Extras	– Pre-wash 	
 <b>Woollens 20 °C</b>		<b>max. 2.5 kg</b>
Use for	Machine-washable woollens and woollen blends.	
Tip	– Use detergent formulated for woollens.	
<b>ECO 40–60</b>		<b>max. 7.0 kg</b>
Use for	Normally soiled cotton items.	
Tip	<ul style="list-style-type: none"> <li>– A laundry load consisting of mixed cottons that are intended for washing at 40 °C or 60 °C can be washed in the same wash cycle.</li> <li>– This programme is the most efficient in terms of energy and water consumption for washing cottons.</li> </ul>	
 <b>Drain/Spin</b>		<b>max. 7.0 kg</b>
Tip	<ul style="list-style-type: none"> <li>– Make sure you select the appropriate spin speed.</li> <li>– Select the <i>Rinse plus</i> Extra for an additional rinse.</li> <li>– Drain only: select 0 rpm for the spin speed.</li> </ul>	
Extras	– Rinse plus 